

701 N. prairieview Rd. #2  
Mahomet, IL

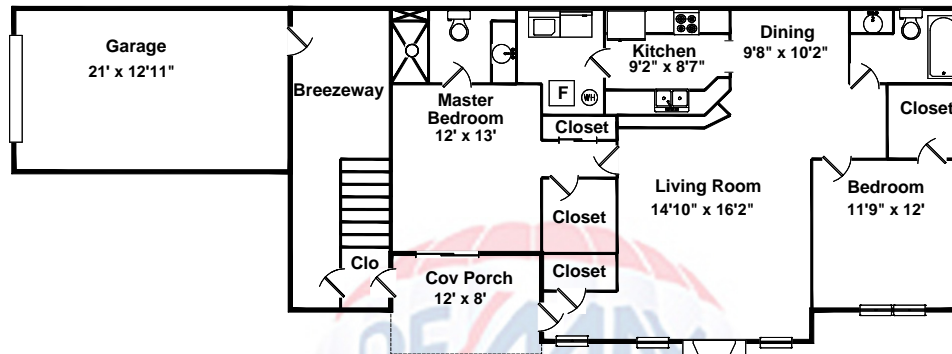

**Area Sizes:**

1st Floor: 1092 sq.ft.  
Garage: 286 sq.ft.  
Porch: 96 sq.ft.  
Breezeway: 192 sq.ft.

Property was measured to Champaign standards  
Information Deemed Reliable and is for Illustration Purposes Only  
Copyright 2006 Homesight-All Rights Reserved  
Interior Room Measurements are Approximate

homesight, inc.

APEX SOFTWARE 800-858-9958

Apix2000-w Apex2

## 701 N. Prairieview Rd. #2 Mahomet IL 61853



### RE/MAX Realty Associates

**Nick Taylor**

Office: 217-586-4906

Mobile: 217-377-4353

Email: [jessicab@taylor-realty.com](mailto:jessicab@taylor-realty.com)

Web: <http://www.taylor-realty.com>



Information Deemed Reliable But Not Guaranteed and is for Illustration Purposes Only - All Interior Dimensions Are Approximate  
Copyright 2014 HomeSight, Inc. - All Rights Reserved

RSS: 3968